



The Society for Pennsylvania Archaeology, Inc. Newsletter Spring 2024

President's Message:

Hello SPA!

I hope all is well with each of you and that the winter season was exhilarating or at least tolerable. The Vernal Equinox and fairer weather are not far away, nor is the 2024 SPA Annual Meeting in Carlisle. There is much to look forward to.

With the upcoming meeting in Carlisle - 12 to 14 April - we will complete our first two-year rotation in dedicated meeting venues with a return to Dubois in 2025. We hope that the Dubois-Carlisle rotation will conveniently serve SPA members from all parts of Pennsylvania and the region. As with any change, some hiccups are expected. We greatly appreciate your patience as we fine-tune the meeting process for both Dubois and Carlisle. The SPA Annual Meeting Committee has been working diligently to ensure a great meeting in Carlisle and planning is already underway for Dubois. Please join us in Carlisle and consider providing an item for auction or a contribution of beverages or snacks for the always popular Hospitality Room – greatly appreciated by all.

The weekend in Carlisle will be packed full of opportunities to learn, share, and engage with friends, colleagues, and students, and to welcome newcomers. The Pennsylvania Archaeological Council will hold its Spring Symposium on Friday afternoon, 12 April. The topic is *Pennsylvania's Moving Frontier*. Paper sessions for the SPA Annual Meeting - *Artifacts to Landscapes: Exploring Pennsylvania Archaeology* - will begin on Saturday morning 13 April and continue through Sunday morning, 14 April. The student poster session will be held on Saturday with Dr. Ben Ford, IUP, as chair. Dr. Jonathan Burns, Juniata College, will provide the Saturday evening banquet talk featuring his research on the archaeology of the French and Indian War in Pennsylvania. New to the mix is the Pennsylvania State System of Higher Education (PASSHE) Undergraduate Anthropology Conference, to be held on Sunday, 14 April, following the morning SPA paper session. Please stay and support the emerging talent of our PASSHE students.

As Program Chair for the 2024 SPA Annual Meeting, I look forward to receiving your paper abstracts. As President, I especially look forward to seeing and speaking with you in Carlisle. Until then!

Yours in archaeology,
Chuck Williams

THE SOCIETY FOR PENNSYLVANIA ARCHAEOLOGY, INC. Encourages submissions for the SPA Jacob L. Grimm C-14 Award

Applicants must complete one copy of the application form for each sample they wish to submit.

Should space be required for additional information, please append as attachment sheets.

DO NOT SEND SAMPLES WITH THE APPLICATION.

Submissions must be reviewed prior to approval by the Jacob L. Grimm C-14 Award Review Committee.

Generally a single sample is approved per year by the committee, but this varies depending on available funding.

Please note that this is a MATCH and only half the sample cost is funded.

Any SPA member in good standing may submit for C-14 samples. SPA Chapters are especially encouraged to submit C-14 samples.

Applications and instructions may be found on the SPA website and will be processed as they are received.

Submission deadline is normally **four weeks prior to the next SPA Annual Meeting**.

Dr. Bernard K. Means, chairman, C-14 Committee, bkmeans@vcu.edu

SPA Annual Meeting 2024/PAC Symposium

Pennsylvania Archaeological Council (PAC)

Spring 2024 Symposium

Friday, April 12, 2024

Carlisle, PA

Call for Papers:

Topic: Pennsylvania's Moving Frontier

Moderator: Dr. Ben Ford (IUP)

Symposium Abstract: The frontier shifted rapidly across trans-Appalachian Pennsylvania during the 18th century, sometimes so quickly that cartographic sources struggled to keep up. The archaeological record, including forts, settlements, and transportation networks, provides the best information about this period in Pennsylvania history and how residents adapted to a rapidly changing landscape.

Submission requirements and details: We invite the submission of paper titles and 150-word abstracts by February 2nd, 2024 to Dr. Jessica Hedgepeth Balkin (Jessica.Hedgebalkin@colorado.edu). Symposium speakers will each be granted an honorarium of \$100 to defray the costs of travel and board. The PAC Symposium committee intends to consider publishing an edited volume from the papers presented.

CALL FOR PAPERS

The 93rd Annual Meeting of

The Society for Pennsylvania Archaeology

April 12-14, 2024

Carlisle, PA

Comfort Suites, 10 S. Hanover Street, Carlisle, PA 17013

Group Rates: \$109.00 Single, King or 2 Queen Beds Early reservations are recommended.

Reservations at (717) 960-1000

Hosted by the Society for Pennsylvania Archaeology, Inc.

Program Chair: Chuck Williams, email: chuckwilliams2019@outlook.com

Presentation at the SPA annual meeting is open to any member of the society in good standing. Papers are limited to 20 minutes and must relate to some aspect of Pennsylvania Archaeology. Individuals are invited to submit an abstract of 150 words or less to Chuck. **NO later than March 18, 2024.**

The Program Committee will evaluate each submission and will notify by email of acceptance, recommended changes based on the nature of the material, or rejection for ethical issues or sensitivities.

Poster Session Chair: Ben Ford

Students wishing to present posters should email their title and abstract **NO later than March 18, 2024** to Ben Ford at: nywg@iup.edu. Please include a copy of your student identification card when submitting. Instructors and students please note: meeting registration costs for students will be covered by the SPA.

Please remember that only members in good standing can present or vote at Annual Meeting. 2024 dues are payable now. Forms may be found on the SPA website along with a paypal option at www.PennsylvaniaArchaology.com.



**Society for Pennsylvania Archaeology 93rd Annual Meeting
April 12-14, 2024**

Hosted by the Society for Pennsylvania Archaeology

Meeting Venue: Comfort Suites, 10 South Hanover Street, Carlisle, PA 17013

Accommodations: Comfort Suites Carlisle

Early reservations are recommended. Reservations at 717-960-1000 ext. 0

YOU MUST DIAL THE HOTEL DIRECT- DO NOT CALL TOLL FREE 800 #

Identify yourself as being with the Society for Pennsylvania Archaeology

Single King - \$109.00, 2 Double Beds - \$109.00

Garage Parking fee is 5.30 per day for registered guests

HOTEL GROUP RATE ENDS MARCH 20, 2024

Registration Form: Please NOTE Banquet reservations must be made prior to April 1, 2024

Name _____

Chapter/Institution: _____

Email: _____ Phone: _____

Address: _____ City: _____ State _____ Zip: _____

**** 2023 auction funds were used to support student registration fees for this annual meeting.**

Registration: \$35.00 x _____ Student Registration: **Free with Student ID** _____

Banquet Buffet: \$40.00 x _____ * Vegetarian or Gluten Free Option- Please circle if applicable

Total Enclosed _____

Mail with your check payable to: Society for Pennsylvania Archaeology
Box 213
New Bethlehem, PA 16242

Mail in registration forms available at www.pennsylvaniaarchaeology.com and can also be completed online via **PayPal** from the website.

Please remember that the Auction at Annual Meeting benefits the Elmer Erb Permanent Fund. The proceeds from the fund provides for the C-14 Committee awards as well as covering student registrations for Annual Meeting and the Elmer Erb Permanent Fund Research Grant. Chapters and Individuals may send or bring donations for the auction to Annual Meeting.

Preliminary Meeting Abstracts:

Greetings from The State Museum of Pennsylvania Archaeology Lab: updates on the William Frederick (Fred) Veigh collection and other recent donations from Western PA , Andrea J. Carr

The archaeology lab set an ambitious year-end goal to fully process Washington and Westmoreland County site resources from the Fred Veigh collection at the outset of 2020. As Burns wrote, “The best laid plans of mice and men often go awry.” Four years and a global pandemic later, the lab can share it is wrapping up Veigh collection inventories and PA-State Historic and Archaeological Resource Exchange (PA-SHARE) updates of these county-related survey areas. This presentation will serve as an overall status report on lab activities and acknowledge recently received Upper Ohio River Basin collection donations from Society for Pennsylvania Archaeology (SPA) chapters and members. It will further summarize and show examples of how comprehensive and well documented watershed surface surveys, like the Veigh collection, contribute to the understanding of Pre-Contact regional site patterning, lithic resource use, and trade and exchange of material culture through the movement of people over time.

Fort Gaddis Then and Now: Adventures in Curating a Legacy Collectio, Kira Heinrich, Calista Baluch, Elizabeth Griffith, and Kamryn Miller

Abstract: Archaeological Investigations were conducted for the Fort Gaddis archaeological site in 1974 as a field school for California University of Pennsylvania. Since shortly after that time, the resulting collection has been in storage and the information gathered from the excavation only accessible through two short articles. Recently the National Road Corridor Heritage Area, PennWest University, California, the Fayette County Historical Society, and Christine Davis Consultants have teamed up on a project to bring the curation of this collection into the 21st century. This winter interns from PennWest started working with staff from CDC in the Fayette County Historical Societies Haddonville School on curation of the artifacts. Find out how the project is progressing and what we are learning about Fort Gaddis and processing legacy collections along the way.

Trade, Migration and Ethnogenesis: The Monongahela-Susquehannock Diaspora, James T. Herbstritt and Thomas K. Harper

The archaeological record of southwestern Pennsylvania suggests that the Monongahela people disappeared from their ancestral homeland shortly after European objects were introduced into the lower Upper Ohio and Potomac Valleys ca. A.D. 1600. Coincident with the Monongahela disappearance from there, a new ceramic type, Strickler Cord marked-which is very much like Monongahela Cord marked-emerges as the principal pottery type at Susquehannock settlements in the lower Susquehanna River valley. The presence of this pottery type, foreign to the region, begins to show up at terminal Washington Boro stage settlements of the 1630s. Its use there continues until ca. 1675, when the Susquehannocks were dispersed into Maryland because of conflict with the Iroquois. We hypothesize that the ancestry of Strickler Cord marked and the potters who made it at Susquehannock settlements can be best explained by the west-to-east migration of Monongahela people out of the lower Upper Ohio Valley. Our presentation will focus on the timing of culture-historical events utilizing comparative archaeological site information, Bayesian sequencing of important sites and materials, and proposed AMS ¹⁴C dating of the occupational sequence at the Foley Farm site (36Gr52). Our goal is to develop a better understanding of cultural interaction between the Monongahela and Susquehannock peoples during a complex period of conflict and European colonial expansion.

Where There's a Weir, There's a Way, Melanie Mayhew

Pennsylvania has over 80,000 miles of streams and rivers. A project to identify V-shaped stone fish weirs in this state has yielded over 280 structures using an array of data sources. Many of these weirs occur on the Susquehanna River and its tributaries, which drain into the Chesapeake Bay. This river is North America's longest non-commercially navigable waterway, and it supported a large fishing industry prior to the construction of hydroelectric dams during the 20th century. This presentation will focus on the identification of weirs in Pennsylvania using remotely sensed imagery and historic documentation. The author will discuss data sources, the development of naming conventions, structure attributes, and their strategy for recording these resources in PA-SHARE. Data resulting from this research can help reveal archaeologically significant areas, support the locations of historically referenced settlements, inform fishery biologists in restoration efforts, and provide a visual reminder of our rivers' historic value.

The Hardyston Jasper District, Justin McKeel

The Hardyston Jasper District was defined by David Anthony and Daniel Roberts in 1988. At that time Anthony and Roberts identified 176 contributing sites, with distribution in the following counties: Berks (27), Bucks (44), Chester (1), Lehigh (77), Montgomery (15), and Northampton (12), generally following the Hardyston Formation. For practical reasons the Hardyston Jasper District was never mapped or defined as a district in SHPO records, and as a result, an undefined number of sites that likely meet the criteria for inclusion in the district were never evaluated as such. Because the district is in a region experiencing intense development, SHPO has reevaluated our records to create and formally designate this district as a resource, refined the district boundary, and identified and evaluated sites for inclusion in the district.

Proposing New Nomenclature for Referencing Indigenous Communities in Pennsylvania Archaeology, Joe Stahlman and Amy Covell-Murthy

Unfortunately, a lot of the language used in archaeological reports, publications, newsletters, and media throughout Pennsylvania is outdated and only speaks to professionals in the field. Nonetheless, the use of language, outdated or not, can perpetuate stereotypes and misconceptions of Indigenous Peoples. Even with the best of intentions, practitioners can unwittingly cause harm with the language they use. Offering two different perspectives, Dr. Stahlman and Covell-Murthy give examples of ways that language can shift to reflect the changing values of our community. This talk will touch on the importance of honoring Indigenous ways of knowing and representation in a museum setting, as well as highlighting one experience of a Tribal Historic Preservation Officer working in a State with very little Indigenous representation. In our ongoing relationship, we have come to believe that collaboration is most successful when all parties are on equal footing in those discussions.

SPA Awards Committee

The deadline for nominations for the Lifetime Achievement, J. Alden Mason and the Archey awards is Friday, **March 15, 2024**. Please submit only typed nomination forms and supporting documentation, including letters of support.

Revised 2024 nomination and eligibility criteria for the awards will be available in early January, 2024. Please go to the society webpage www.PennsylvaniaArchaeology.com to find the revised form(s). Please email completed awards packets to John Nass, Awards Committee chairperson, at nass81@breezeline.net. *Questions and those seeking assistance completing awards nomination packets should also be directed to John Nass as well.*

Election at Annual Meeting
Elmer Erb Permanent Fund Trustees Nominees to serve 6 year term ending in 2030
Phillip Neusius
Gregory D. Lattanzi

Meeting Scholarships

2024 James W. Hatch Scholarships--Reminder

The Pennsylvania Archaeological Council (PAC), in cooperation with the Society for Pennsylvania Archaeology (SPA), will again award scholarships to enable students of archaeology to attend the annual joint SPA/PAC meeting, April 12-14, 2024, in Carlisle, Pennsylvania. We anticipate that up to four awards of \$150 apiece will be made. We encourage all current college or high school students with a demonstrated interest in Pennsylvania archaeology and the activities of the SPA to apply, although preference will be given to students planning to present papers or posters at the meeting. Applications, in the form of a brief letter of interest explaining the student's background and qualifications for the award, should be sent by mail or e-mail by **April 7, 2024**

to: Paul Raber, praber@heberlingassociates.com or (717) 547-5558
Heberling Associates, Inc.
904 Main Street, PO Box 376
Alexandria, PA, 16611

The W. Fred Kinsey Meeting Scholarship Reminder

The W. Fred Kinsey Meeting Scholarship provides student membership to The Society for Pennsylvania Archaeology (SPA) for one year, a \$150.00 award, and banquet costs for the annual SPA meeting. Students currently pursuing an undergraduate or graduate degree are eligible to apply for the W. Fred Kinsey Meeting Scholarship. Students are not required to attend Pennsylvania institutions, but research must be relevant to Pennsylvania Archaeology. Eligibility is dependent on a complete, single-author paper with PowerPoint slides (if appropriate) to be presented at the annual meeting scheduled for April 12-14, 2024, in Carlisle, PA. Abstracts for papers should be sent to the Program Chair, Chuck Williams (chuckwilliams2019@outlook.com) please check the webpage for submission details.

<https://www.pennsylvaniaarchaeology.com/AnnualMeeting.htm>

Selection of the winning paper is decided by committee review and will be based on quality of original research, presentation, and appeal to the avocational and professional archaeology community. The committee consists of at least three members of the Society: one member from the PHMC, one member from the education committee of the Society, and the annual meeting program chair or her/his designate. This is an opportunity to present your research with the goal of publishing in a future journal of the Pennsylvania Archaeologist.

Look for other Scholarships and Meeting News available on the SPA Website

2024 Annual Meeting - Auction Notes

The organizing committee for the Annual Meeting has opted for a mix of a Silent Auction and traditional auction of specialty items at this year's meeting. Donations of gift baskets should include a minimum bid price and the bid sheets will reflect the opening bid price. Please tuck a card in the basket or tie it on the outside suggesting a minimum starting bid. **If you are bringing books to the auction- please bundle them (4-5 per bundle) by subject.** The proceeds from the auction benefit the Elmer Erb Fund and the Annual Meeting fund. We have been able to offer free registration to students from the funds raised at the auction.

*** Please remember to bring auction items which are "revolving" items – **Stan Lantz's painting and Dick George's red toolbox.** Auction items will be on display in the book room and bidding will be open Saturday. Bidding will close at 3:00 pm on Saturday – the winning bids will be announced at the close of the presentations on Saturday.

Join us in Ohio for the 2024 SPA Field Trip!

Exploring Ohio
Hopewell and World
Heritage
June 14-17, 2024

It's time to return to Ohio and learn more about the Hopewell Culture, the Ohio earthworks and mounds, and recent archaeology and interpretations. 2023 marked both the designation of eight of Ohio's mound and earthwork complexes as World Heritage Sites and the 100th anniversary of the establishment of a monument to the Hopewell culture in Chillicothe. This makes the summer of 2024 a great time to make this trip and get up to date on what has been happening in Hopewell archaeology and interpretation.

We plan to visit Serpent Mound, the Fort Ancient site, several sites at the Hopewell Culture National Historic Park, and Newark Earthworks, learning from the archaeological experts in each case. We also will have dinner at the historic Golden Lamb restaurant and go to the outdoor drama *Tecumseh!*

Please join us! Full information on registration and hotel costs will be available before April 1 on the SPA website (www.pennsylvaniaarchaeology.com) and through SPA chapters. Because we will be carpooling, the trip is a BARGAIN. Per person costs are expected to be ca. \$150 to the SPA for members and first guests (\$175 for non-members) and hotel costs are estimated at about \$230 (double occupancy). In the meantime, contact John Nass (nass81@atlanticbb.net) or Sarah Neusius (sraahneusius@gmail.com) with any questions and mark your calendars!

SPA Annual June Field Trip Will Explore Ohio Mounds and Earthworks

The 2024 Annual SPA Field Trip will focus on the Hopewell mound builders of Ohio. We will visit many of the sites included in the Hopewell Ceremonial Earthworks designated as World Heritage sites in 2023 (<https://whc.unesco.org/en/list/1689/>) during the one hundredth year since the National Park Service established the Mound City in Chillicothe as a national monument. This site was later expanded in the Hopewell Culture National Historic Park. Since it has been almost a decade since our field trip focused on the Ohio earthwork sites (2015), it will be a good time to learn about the world heritage designation and what the latest research has been finding out. As usual, it will also be fun to be together seeing archaeological sites and learning about the past.

The details of our plans are still being worked out, but we can share the broad outlines of the trip. We will have an orientation gathering in the evening on Thursday, June 14 at our hotel in Wilmington, Ohio. Current plans are to visit both Serpent Mound and the Fort Ancient State Memorial on Friday. We are in touch with archaeologists from the Ohio History Connection, which manages both sites, about these visits. A group dinner at the historic Golden Lamb restaurant, founded in 1803 in Lebanon, Ohio, is also being planned. After two nights in Wilmington, we will head to Chillicothe, Ohio for Saturday night. We are working with the archaeologists at the Hopewell Culture National Historical Park in Chillicothe to plan a day visiting this park and seeing sites included in it such as Hopewell, Hopeton, Mound City, and others. Saturday evening, we are reserving group tickets for the famous outdoor drama *Tecumseh!* This production focuses on the life of this famous Shawnee Indian leader and is held each summer at the Sugarloaf Mountain Amphitheater in Chillicothe (<https://tecumseh-drama.com/event/tecumseh/> .) On Sunday, we will be visiting the impressive earthworks at Newark, Ohio as our last stop, where we are arranging for an archaeologist to lead our group. We expect to disperse and head home early Sunday afternoon from Newark.

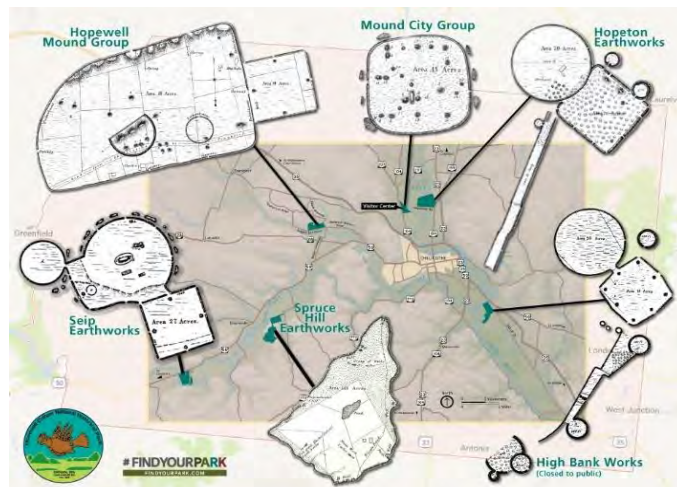

Earthworks included in the Hopewell Culture National Historic Park (<https://www.nps.gov/hocu/learn/historyculture/places.htm>)



2015 Field trip participants visit Mound City

This trip is a wonderful opportunity to see sites and learn about the Hopewell people. This is especially true because, as indicated in the Winter Newsletter, we are trying to keep the costs down by organizing this trip without a bus. The plan is to carpool from the hotels where we are staying. Participant information packages will include directions and maps as well as details about the sites being visited, but once we gather on Thursday night, not everyone will have to drive. In fact, it may be better to have fewer cars to park. The cost to the SPA will include entrance fees, at least two picnic lunches, dinner at the Golden Lamb, and the *Tecumseh!* tickets. Once again, we will ask participants to make their own

hotel reservations at the negotiated group rates. The great news is that without a bus, we estimate that we will be able to keep the SPA cost to only \$150 for members and their first guest, which is less than half of last year's cost. Estimated double occupancy hotel cost for three nights is about \$230/person.



We hope you will find this trip reasonable in cost and plan to join us this year. Sometime before April 1 we will have registration forms, and hotel information. Watch for this information on the SPA website (www.pennsylvaniaarchaeology.com). These details will also be distributed to SPA chapters and officers and be available at the annual meeting in Carlisle. In the meantime, questions can be directed to John Nass (nass81@atlanticbb.net) or Sarah Neusius (sraahneusius@gmail.com .)

Happening at the State Museum of Pennsylvania

The State Museum of Pennsylvania archaeology lab set an ambitious year-end goal to fully process Washington and Westmoreland County site resources from the William Frederick “Fred” Veigh collection at the outset of 2020. Four years and a global pandemic later, the lab can share, in addition to fully processing resources related to the Washington East USGS topographic map quadrangle of Washington County, reported in progress the winter of 2022-2203 (final tally: 74 sites; 49,670 total artifacts), we have now finished artifact inventories and are working through the last few PA-State Historic Archaeological Resource Exchange (PA-SHARE) updates for the (75) Westmoreland county-based archaeological sites received in the donation.

Overall, Westmoreland County associated sites and non-sites account for (15,248) artifacts and include surface collections from several well documented multi-component Pre-Contact/Monongahela village occupations, such as Squirrel Hill Bottoms Lands (36WM0035), Household (36WM0061), and the Consol site (36WM0100). Early surface surveys conducted by Carnegie Associates and Society for Pennsylvania chapter (SPA) members, like Mr. Veigh, recorded these sites and led to later large-scale investigations curated for future study at institutions such as the Carnegie Museum of Natural History (CMNH), Indiana University of Pennsylvania (IUP; field school investigations ongoing at Squirrel Hill), and The State Museum.

(Thank you, Westmoreland Chapter 23, once again for your recent donation of field records and artifacts recovered from multi-decade excavations at the Consol site! And it’s hard to talk about site survey in Westmoreland County without shouting out the dedication of Bob Oshnock, Jacob Grimm, Ron Eisert, and several others who have themselves, or whose loved ones have donated their expansive survey collections to the museum over the past ten years.)



Mr. Veigh contributed to the eventual listing of Squirrel Hill on the National Register of Historic Places (NRHP) in 1980. He documented SPA Conomoch Chapter 16 investigations with Carnegie in 1976 and provided site photographs for the final Pennsylvania Historic and Museum Commission (PHMC)-sponsored nomination. The Archaeological Conservancy acquired the site in recent years. Beyond his work to preserve the site, Mr. Veigh’s collection from Squirrel Hill has contributed to greater regional research projects initiated by William Johnson (2001; Johnson and Means 2020), prior to donation, and IUP graduate students Amanda Filmyer (2022) and Bridget Roddy (2023), post-donation to the museum.

William Johnson cordage casts, Veigh Collection pottery, Squirrel Hill (36WM0035), curated at The State Museum of Pennsylvania.

As we process site-related assemblages, lab staff has updated PA-SHARE at the resource (site) level with artifact summaries, catalogs, and diagnostic artifact images. It is a goal for 2024 to work with the PA State Historic Preservation Office (SHPO) staff to summarize these resources into survey records grouped by meaningful geophysical or thematic data such as watershed sub-basin groups, geographic areas, and/or historically documented Indian paths.

One such potential survey area worthy of mention in the Veigh Collection is a section of the Ligonier Valley between modern day Ligonier and New Florence (Wilpen quadrangle). This geographic area is further bound between Loyalhanna Creek in the Kiskiminetas River watershed and the Conemaugh River and is associated with major north-south and east-west trails (Catawba and

Raystown Paths). Mr. Veigh recovered artifacts made from either South Mountain metarhyolite, extra-regional sourced quartzite, or both from twenty-one recorded sites and one non-site locus in this defined survey area. The presence of both exotic quartzite and metarhyolite at archaeological sites in this Laurel Highland valley, predating the Contact Period, is evidence that these were well traveled native pathways for many millennia. Andrea Carr will present further on this topic at this year's annual meeting in April.



Ross # 2 site (36WM0190), Veigh Collection. Top Row: contracting stem quartzite and South Mountain metarhyolite broad spears, Bottom Row: chert hafted biface fragment and notched points.

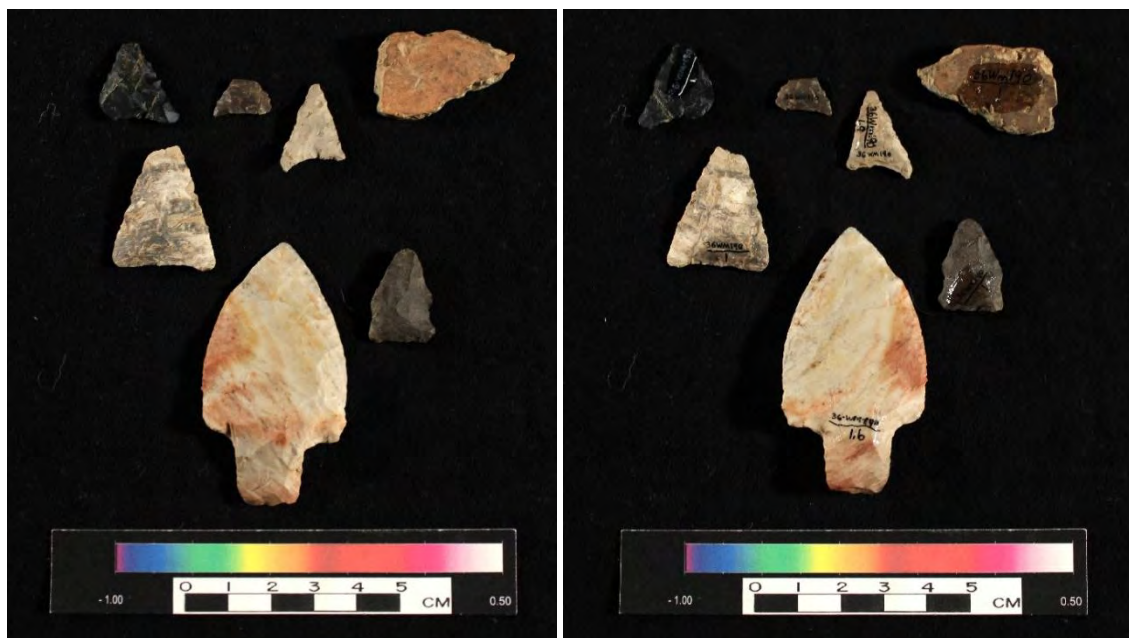

Ross # 2 site (36WM0190), Veigh Collection. Woodland diagnostic artifacts, obverse, and reverse view.

Projectile points and tools made from exotic lithic materials originating to the east (quartzite and South Mountain metarhyolite) and the west (Adena/Cresap contracting stem point, Flint Ridge chert) collected at Ross # 2 (36WM0190) exemplify the long-distance movement of people, goods, and ideas along these major pathways in western Pennsylvania.

Sources

Filmyer, Amanda M.

2022 The Squirrel Hill Site: A Study of Cultural Amalgamation and Identity Using Raw Material Analysis. Master's Thesis. Indiana University of Pennsylvania. Digital copy on file, SMOP, Section of Archaeology.

Johnson, William

2001 The Protohistoric Period Monongahela and the Case for an Iroquois Connection. In *Societies in Eclipse: Archaeology of the Eastern Woodlands Indians, A.D. 1400-1700*, edited by D.S. Brose, W.W. Cowan, and R. C. Mainfort, Jr. pp. 67-82. Smithsonian Institution Press, Washington, D.C.

Johnson, William C. and Bernard K. Means

2020 The Monongahela Tradition of the Late Prehistoric and Protohistoric Periods, Twelfth to Seventeenth Centuries AD in the Lower Upper Ohio Drainage Basin. In, *The Archaeology of Native Americans in Pennsylvania, 2:10:345-384*. Eds. Carr et al., University of Pennsylvania Press. Philadelphia, Pennsylvania.

Roddy, Bridget Cecilia

2023 Using Ceramic Analysis to Evaluate Monongahela and McFate Cultural Interactions at the Squirrel Hill (36WM0035) Archaeological Site. Master's Thesis. Indiana University of Pennsylvania. Digital copy on file, SMOP, Section of Archaeology.

A Trip Through the PASS—The 2023 Annual PASS Report Taylor Napoleon, PASS Coordinator, Pennsylvania State Historic Preservation Office

[The Pennsylvania State Historic Preservation Office](#) (PA SHPO) recently published the annual report detailing site recording and survey efforts undertaken by the Pennsylvania Archaeological Site Survey (PASS) program in 2023. In total, 309 new archaeological sites were added to the PASS files, bringing the statewide total to 27,010 recorded sites. The majority of new sites were recorded through cultural resources management (CRM) projects, however, there was an increase in site recording from university research projects. In addition, we continued to see contributions from the Society for Pennsylvania Archaeology (SPA), SHPO managed surveys, independent research projects, and members of the public.

In 2023, SPA members from Chapters 22 (Ohio Valley), 23 (Westmoreland), 24 (Bald Eagle), 29 (North Fork), 30 (Venango) and 31 (Hawk Mountain) recorded 12 new sites in Armstrong, Bulter, Lancaster, Monroe, Schuylkill, Venango, and Westmoreland counties. These included Pre-Contact period habitation sites, historic industrial sites, and rockshelters. In addition, SPA members from Chapters 24 (Bald Eagle), 29 (North Fork) and 31 (Hawk Mountain) updated 6 previously recorded sites with new information.

Of the 67 counties in Pennsylvania, 52 had at least one newly recorded site. The top counties with the most sites recorded last year are as follows: Westmoreland, Indiana, Northampton, Lancaster, Allegheny, McKean, Bulter, Northumberland, Columbia, Franklin, Mercer, and York. This year's PASS report contains contributions from four guest authors highlighting various projects that contributed to the PASS files. If historic sites, Paleoindian sites, and French and Indian War forts interest you, be sure to check out the full articles in the [2023 PASS Report](#). We greatly appreciate all our guest authors' contributions.

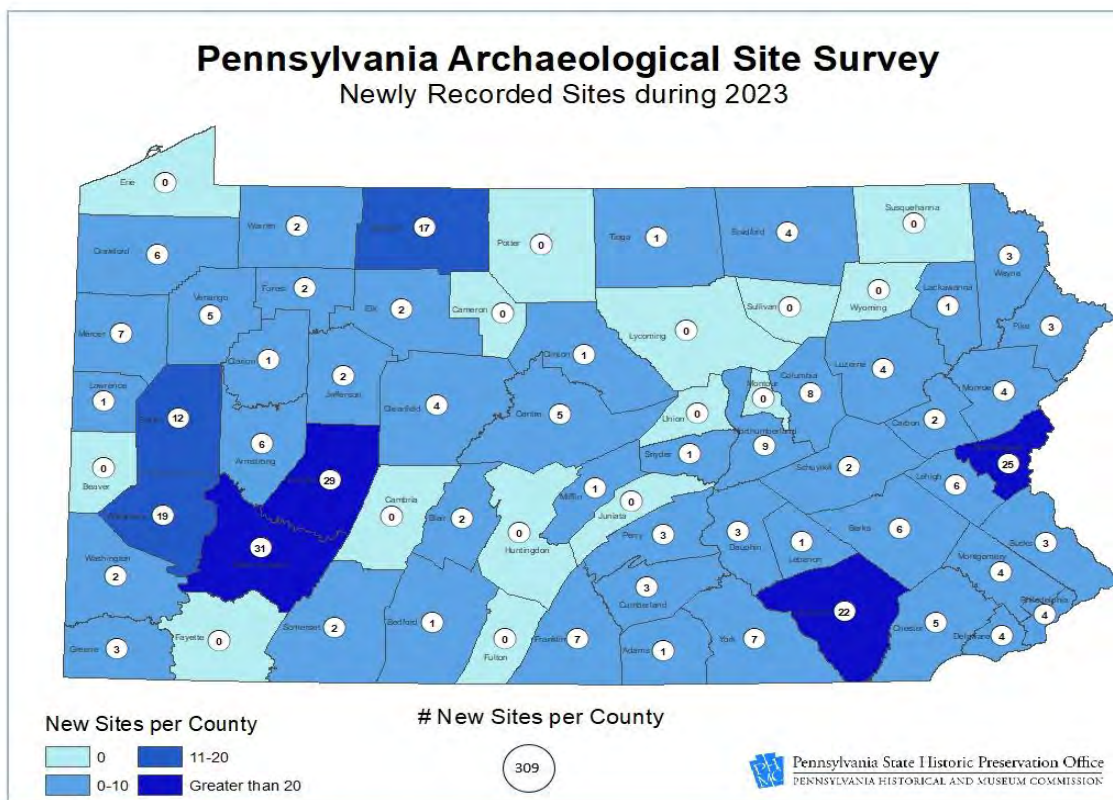

PA SHPO Survey Activities

In 2023, the PASS program continued to progress with survey initiatives from the previous year as well as make improvements to the systems used to capture and share archaeological site information. A summary of PASS program activities is provided below, to learn more please see the [2023 PASS Report](#).

In early 2023, the PA SHPO began work on PA-SHARE 2.0- a large scale, multi-year effort to update and improve PA-SHARE and Surveyor. The most noteworthy upgrades for the PASS program are the changes

to the archaeological resource pages. These changes stemmed from a desire to organize the information in a more cohesive way and present important site details more prominently.

Field school excavation in progress around on of the stone hearth foundations uncovered at Fort Halifax (36DA0008)



Year 3 of the baseline survey initiative kicked off in 2023 resulting in the identification of 392 potential archaeological sites throughout 18 counties. Of these potential areas, 14 were determined to include adequate information to receive an official PASS number. Areas that did not receive PASS numbers serve as opportunities for future archaeological research and investigations. A full explanation of baseline survey and how archaeology is incorporated can be found [here](#).

During 2023, the initial plans for the archaeological phase of the PHMC properties survey initiative were solidified and funding was secured to conduct an archaeological constraints analysis for approximately four properties. The constraints analysis will gather available information on previously recorded archaeological surveys and sites on the property and assess the potential for the presence of both historic and Pre-Contact period archaeological resources. Execution of the archaeological phase of the PHMC properties survey is scheduled to begin later this year.

The PASS program would like to thank all those that contributed to and supported our efforts this year! We looked forward to continuing a collaborative, informative, and engaging PASS program in 2024. For more information on site registration and survey, please contact Taylor Napoleon at tnapoleon@pa.gov.

To learn more about site recording and survey initiatives in 2023, please see the full 2023 PASS Report here: https://www.phmc.pa.gov/Preservation/About/Documents/PASSREPORT_2024_Final.pdf.



Figure 4: Cold cellar associated with Lechauweki Springs Park (36LH0401) in Lehigh County, recorded as a result of baseline survey in 2023.. The Lechauweki Springs summer resort operated between 1873 and 1891. The buildings were fully demolished in 1955 but a few structures remain including this cold cellar.

NEWS From THE STATE MUSEUM OF PENNSYLVANIA

The Section of Archaeology is Open for In-Person Visits -

The Section of Archaeology is now open for scholarly research in our labs and offices and for deliveries of collections. Please contact Paul Nasca at pnasca@pa.gov for more information or to set up an appointment for research or collection delivery.

Charter Day

Celebrate the 343rd birthday of Pennsylvania with free admission to PA Trails of History sites and museums and view Penn's Charter at the new Pennsylvania State Archives on Sunday, March 10. See the Trails of History Press release for Charter Day free admission to the State Museum and historic sites at <https://www.media.pa.gov/Pages/PHMC-Details.aspx?newsid=453>.

Social Media

The Section of Archaeology's Senior Curator Paul Nasca recently gave an online presentation entitled "Historical Archaeology and the Search for the Early Philadelphia Potter, Branch Green", which is available to watch at https://www.youtube.com/watch?v_rhl-14tkOsl. In his presentation, Paul discusses the differences between Precontact and historical archaeology, how historical archaeology is conducted, and his search for the pottery of the elusive Philadelphia ceramic maker Branch Green.

We also encourage you to check out our other YouTube presentations at

<https://www.youtube.com/user/PaTrailsofHistory> and the latest videos at *PA History 2 Go* - a series of short 3-5 minute presentations from across the PHMC sites and museums at www.phmc.pa.gov/Museums/PA-History-2-GO/Pages/State-Museum-of-Pennsylvania.aspx. And please, continue to check out our posts on Facebook!

Keystone Internship in the Section of Archaeology

The Section of Archaeology will have the assistance of an intern for the 2024 summer season. The selected intern will acquire hands-on experience working with artifacts from an important historic site in Philadelphia. The intern will learn how to use the PA-SHARE geographic information system for recording archaeological sites, develop curation skills, learn museum practices and procedures, and assist the archaeology curators.

The Pennsylvania Historical and Museum Commission select interns each year at The State Museum of Pennsylvania and many of its historic sites under the Keystone Internship program. Applications are generally solicited in January for that year's positions and the interns chosen in March. Check back in the fall for an update on our intern and the results of the intern project!

Save the Date! - 2024 Annual Workshops in Archaeology

State Museum of Pennsylvania, 300 North Street, Harrisburg

Saturday, October 26, 2024

The theme of this year's program for the workshops has not yet been decided but will center on an important aspect of Pennsylvania's diverse and interesting archaeological past. The workshops will be held in conjunction with the PAC Fall Business Meeting, which will be held at The State Museum. Please save the date and plan to attend!

18th Annual Colonial Fort Halifax Festival

May 4, 2024, Fort Halifax Park, Halifax, Pa

The Section of Archaeology will be attending the Colonial Fort Halifax Festival on Saturday, May 4th at Fort Halifax Park. Artifacts recovered from archaeological excavations at the park and from Fort Hunter and Fort Augusta will be on exhibit and curators from the Section of Archaeology will be on hand to answer questions.

SAVE THE DATE! Archaeology Month in Pennsylvania

The Meadowcroft Rockshelter and Historic Village, in partnership with the Society for Pennsylvania Archaeology and the Senator John Heinz History Center, are pleased to announce the theme for the 2024 Workshop in Archaeology “*Curation and Management of Small Museum, Family, and Avocation Collections.*” The guest speakers will share with attendees **best practices** for managing and preserving small museum and private collections for display and for long term curation. The date for the one-day workshop is **Saturday, October 19**. Registration form will be posted to SPA website, and made available by email to members during the summer.

The SPA has received a donation in honor of Dr. Stanley Lantz from Richard Haverlack.

Thank you.

Donations may be made in memory of or in honor of someone special in your life.

To donate go to the SPA website at www.PennsylvaniaArchaeology.com or send directly to the Treasurer, SPA at P.O. Box 213, New Bethlehem, PA 16242

News from Westmoreland Archaeological Society, Chapter 23

* The Westmoreland Archaeological Society will exhibit a range of artifacts and engage with the public at the Charter Day event on Sunday, March 10, 2024, from 12:00 p.m. to 4:00 p.m. at Bushy Run Battlefield.

* The West Jefferson Hills Historical Society and the Westmoreland Archaeological Society will host a lecture on the Consol Site (36wm100) at 925 Old Clairton Road, Jefferson Hills, PA on June 25 at 7:00 p.m.

* The Westmoreland Archaeological Society will host their annual summer picnic at the historic Henry House in Mingo Creek County Park on June 15, 2024. The address of the venue is Mansion Hill Rd, Venetia, PA 15367. The specific time of the event will be announced in a future newsletter.

*The Greater Tri-Town Area Historical Society in Dawson, Pennsylvania is partnering with the Westmoreland Archaeological Society to host an artifact display event that will also provide an opportunity for public engagement. The event is scheduled to take place on July 13th, from 11:00 am to 2:00 pm. During the event, members of the Westmoreland Archaeological Society will showcase a range of artifacts and interact with the public in an educational and informative way. This is an exciting opportunity for individuals to learn about the history and culture of the region.

*The Westmoreland Archaeological Society is pleased to announce the opening of our new laboratory and library in Elizabeth, PA. Although the facility is still a work in progress, we are excited to start organizing and equipping it with the necessary laboratory equipment. If anybody has or knows of anybody that has archeology or historical books and equipment for a lab please contact Jim Barno at nimpsa12@yahoo.com

Field School Reminders: *Students from Indiana University of Pennsylvania (left) and California University of Pennsylvania (right) smile from their unit at the 2016 IUP archaeological field school.*



Indiana University of Pennsylvania (IUP) will offer an Archaeological Field School this summer from May 20 to June 28, 2024, at the National Register listed site of Squirrel Hill (36Wm0035), located in New Florence, Pennsylvania. The 2016 and 2022 archaeological field schools confirmed the presence of a Johnston-phase occupation (ca. 1590 A.D.), revealed at least two earlier potential cultural components (ca. 1300 A.D. and 400 A.D.), and demonstrated that the actual site boundaries extend beyond the current Archaeological Conservancy's landholdings. Excavations also indicated that occupation of the site was more complex than initially believed. Of particular interest, ground penetrating radar identified a large rectangular structure significantly different in both size and shape from typical Monongahela domestic structures. This summer's field school will focus on

clarifying the nature of the pre-Johnston Phase occupations, determining how large the site was, finding the central plaza and/or site stockade; and ground-truthing the rectangular structure identified in 2016.

The field school will combine traditional excavation techniques with geophysical survey, shovel testing, and soil coring. Three courses are offered: 1) ANTH 320 (6 cr.), designed for undergraduates; 2) ANTH 520 (6 cr.), designed for graduate students with minimal or no previous experience; and 3) ANTH 740 (4 cr.), designed for advanced graduate students seeking supervisory experience. ANTH 740 students will design an independent research objective and supervise a small crew of undergraduate students to address their research question. Class will run Monday through Friday, 8:00am through 5:00pm. Transportation to and from the site will be provided by IUP, with rides leaving from McElhane Hall. Housing is available through the IUP Office of Housing & Residence Life, or can be obtained individually in town.

A Public Archaeology Day is being planned for those who wish to see the site (and get their hands dirty!) but not register for the entire course. For more information or an application, please contact Lara Homsey-Messer (lmesser@iup.edu), Bill Chadwick (wchadwic@iup.edu), or call the IUP Department of Anthropology at 724-357-2841. Additional information on previous Squirrel Hill excavations can be found at <https://www.iup.edu/anthropology/research/excavations-at-the-late-monongahela-squirrel-hill-site/>.

Underwater Cultural Resource Management Field School in Lake Erie

Until approximately 4,000 years ago, Lake Erie was lower than it is today, leaving large swaths of the modern lake bottom open for habitation. During earlier times, the lake basin contained two smaller lakes connected by a wetland and stream. This mixture of environments would have been attractive to humans, and the quick filling of the basin likely preserved sites in situ. By combining marine remote sensing, geoarchaeology, and Indigenous knowledge, we will identify areas on the lake floor that likely contain submerged habitation sites.

This field school employs a Cultural Resource Management (CRM) approach. CRM, the legally required management and protection of our shared heritage, requires archaeologists to do more than just archaeology. CRM requires an understanding of legal frameworks, professional ethics, consultation, and project management. Conducting CRM in an underwater environment also requires specialized skills in marine remote sensing, landscape reconstruction, and, occasionally, SCUBA diving. This field school teaches the skills of underwater Cultural Resource Management through research on the submerged landscapes of Lake Erie. This program will not focus on shipwrecks (the more academic side of marine archaeology) but on understanding submerged landscape as this is the mainstay of Marine CRM work and where the greatest need for trained marine CRM professionals is. The skills taught in this course are similar to those employed in CRM to identify sites prior to offshore energy (wind, oil, and gas) development. This course is appropriate for students interested in both Cultural Resource Management and traditional academic archaeology in an underwater environment.

This field school is offered through the Center for Field Sciences.

Dates: July 14 to August 10

Location: Erie, PA Tuition: \$4810 (includes 8 semester credits)

Instructors: Ben Ford (Indiana University of Pennsylvania), Joe Stahlman (Seneca Nation of Indians), and Jessi Halligan (Texas A&M University)

For more information and to enroll: <https://www.fieldsciences.org/program/2024-us-pa-lake-erie/>

Support for Field School attendance will be an agenda item for the upcoming PAC and SPA Board of Directors Meetings in April. Expenses are often out of reach for students and as evidenced above the schools with room and board can be quite costly. If you have a suggestion for helping to offset or pay for the costs of field schools for deserving students please offer that to board members before the April 12th meetings. Thank you.

Elmer Erb Permanent Fund Research Grant

The Trustees of the Elmer Erb Permanent Fund are interested in providing funds to support Pennsylvania archaeology – research that will enhance our understanding of past cultural behavior. In support of that goal, we have developed a grants program for students and non-professional members of the Society for Pennsylvania Archaeology. Award of funds is dependent on a research proposal detailing methods, significance of the project and the feasibility of completion within 18 months. The application form is available on the Society for Pennsylvania Archaeology website.

- Proposals should be submitted in electronic format at erbresearch22@gmail.com.
- **Grants are restricted to students (currently registered at an accredited college or university) or avocational archaeologists who are members of the Society for Pennsylvania Archaeology.**
- The grant can be used in research to enhance our understanding of past cultural behavior in Pennsylvania such as travel, expendable supplies, equipment rental, remote sensing studies, radiometric dating, or curation fees.
- The application deadline is December 31st.
- The maximum award is \$1500.00 per applicant.

Applications will be accepted for calendar year ending December 31st; awarded applicant/s will be notified by March 1st.

[Elmer Erb Permanent Fund Research Grant Application](https://pennsylvaniaarchaeology.com/Awards.htm) is available at <https://pennsylvaniaarchaeology.com/Awards.htm>

Upcoming Deadlines

Annual Meeting registration: Group Room Rate, **March 20, 2024**

Banquet Tickets, **April 1, 2024**

Call for Papers and Poster session deadline, **March 18, 2024**

James W. Hatch Scholarship deadline **April 7, 2024**

W. Fred Kinsey Student Scholarship deadline **See website.**

Nominations Annual Awards deadline **March15, 2024**

Dues Reminder: 2024 annual membership dues are now payable.

Only members in good standing may vote at Annual Meeting, hold office or present papers.

Chapter and Membership Obligations

Annual Chapter report forms have been mailed or emailed to the individual chapters. This report details chapter activities for the previous year (2023). This report is a chapter obligation under the SPA constitution.

Chapter reports and officers to Secretary for calendar year 2023 **due March 15, 2024**

All SPA chapters are required to report **chapter officers** to the Secretary **annually**. This report is necessary for maintaining current contact information for all chapters. Please report officers even if there has not been an election or change of positions in your chapter. Please include addresses, phone numbers and email addresses if possible.

The Society for Pennsylvania Archaeology, Inc.
P.O. Box 213
New Bethlehem, PA 16242

RETURN SERVICE REQUESTED

Time to renew your
SPA 2024 membership

The Society for Pennsylvania Archaeology, Inc.

Officers 2024

President: Chuck Williams, chuckwilliams2019@outlook.com
First Vice President Angela Jaillett-Wentling, Angela.jaillet@yahoo.com
Second Vice-President Ben Ford, Ben ford@iup.edu
Secretary: Judy M. Duritsa, 301 North Drive, Jeannette, PA 15644 or e-mail at: jmduritsa@comcast.net
Treasurer: Kenneth Burkett, P.O. Box 213, New Bethlehem, PA 16242, kenburkett@comcast.net
Editor: Roger Moeller, alchemy60@sbcglobal.net
Webmaster: Roger Moeller, alchemy60@sbcglobal.net
Facebook: Jonathan Libbon, jlibbon@gmail.com

Send SPA Newsletter information to the Secretary

Newsletter Deadline: September 1, 2024

The Society for Pennsylvania Archaeology, Inc. was organized in 1929 to: Promote the study of the prehistoric and historic archaeological resources of Pennsylvania and neighboring states; Encourage scientific research and discourage exploration which is unscientific or irresponsible in intent or practice; Promote the conservation of archaeological sites, artifacts, and information; Encourage the establishment and maintenance of sources of archaeological information such as museums, societies, and educational programs; Promote the dissemination of archaeological knowledge by means of publications and forums; Foster the exchange of information between the professional and the avocational archaeologists

To subscribe to the SPA Newsletter by email, contact the newsletter at: jmduritsa@comcast.net
All **current updates** are available at www.PennsylvaniaArchaeology.com and our Facebook page.